

Company introduction:

Anhui Zhongke Optic-electronic Color Sorter Machinery. is a high-tech enterprise specializing in the R&D, production and sale of intelligent color sorters. The company is located in Baiyan Technology Park in Hefei High-tech Development Zone of China, with an area of 100,000 square meters, 22,000 square meters of modern workshops and 25,000 square meters of scientific research buildings. Moreover, the company has invested a total of 150 million in constructing workshops and purchasing facilities, including more than 100 sets of sophisticated machines like chip welders, laser cutters and CNC systems. These investments allow the company to have an annual production capacity of 5,000 sets of intelligent color sorters and an annual output of 200 million, and become one of the largest production bases of intelligent color sorters.

The dedicated R&D center bases in Hefei, a national science and education base, as a tactic to support the company's research and development efforts. The company has also established a R&D team composed of experienced engineers and headed by leading optoelectronic experts in China, who demonstrates strong capability in research and development, extraordinary innovative ideas, and pragmatic R&D initiatives. In particular, the company has developed its AMD series of color sorters, for which the company received exclusive intellectual property rights, by applying its research and manufacturing experience accumulated over the past 30 years. These optical sorters enable precise optical sorting operations for rice, coarse cereals, tea, mineral and special materials. Consequently, the company grasps more than 30% market share in Chinese market, and the products are successfully exported to the United States, Brazil, India, Russia, Canada, Southeast Asia and other countries and regions.

In the concept of "Win Customer's Trust by Quality Products, Obtain Confidence from Superior Services", the corporate tenet of "Win Customers with Honesty and Good Repute" and the service concept of "Service is Available at Any Time", the company is looking forward to establishing cooperation with new and old friends for common benefits.



FACTORY OVERVIEW



Optical sorting solutions add value throughout your mining process

The technology separates ore from gangue – unwanted material – on a rock-by-rock basis, delivering reduced dilution, lower strip ratios and transport costs, removed contaminants and optimized process flows.

Benefits of sensor-based mineral sorting at a glance.

Contaminant removal: 1,Contaminants can be removed early in the separation process, reducing crushing and classification costs, increasing recovery and enhancing deposit exploitation.2,Product upgrade: Final product can be produced in higher quantities and with its quality improved, which ultimately means increased revenue.

Optical sorting technology

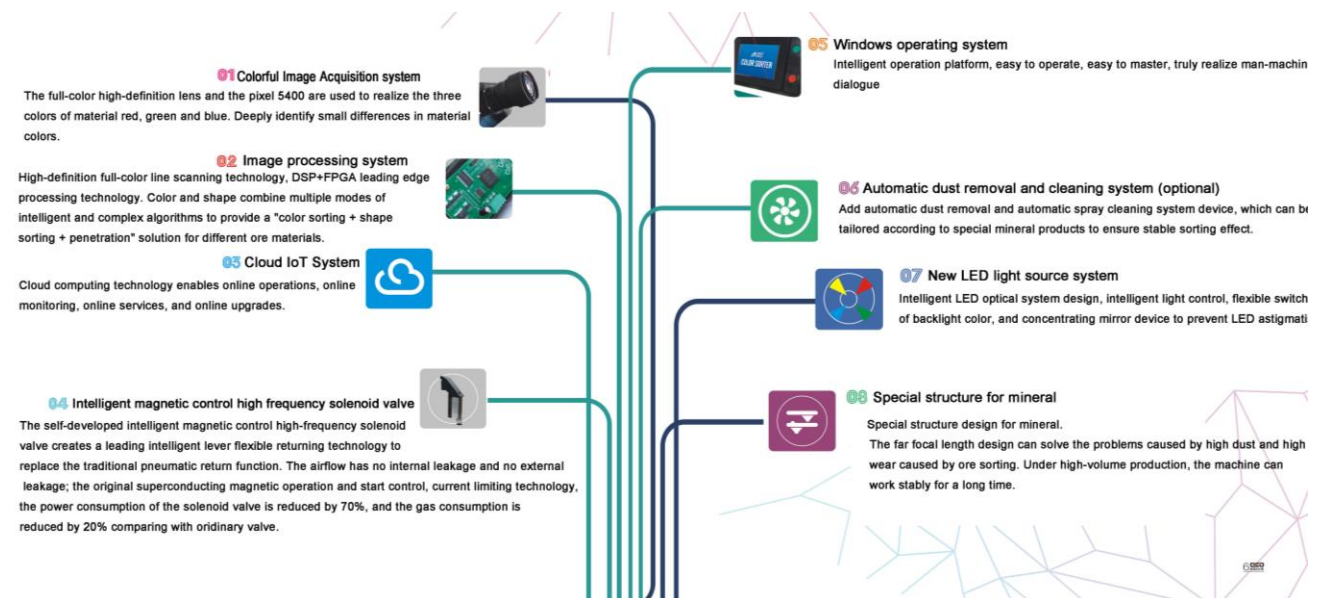

Ore Sorting						More info
	HK-3008-1Z	HK2256-2Z	KS1200-B	DKS1280-B	HK1200-1G	

1, optical sorter for ore powder size(26-120mesh)



Features:

- 1, Vertical chute solves the problem of powder and track sticking during powder ore sorting
- 2, Suitable for the ore particle range from 26mesh to 120mesh
- 3, The slides are made of high-density alloy and are resistant to wear and scratches.

Specification

Model	HK3008-1Z		HK1504-2Z	
Output(t/h)	26-40 mesh	5.0-10.0	26-40 mesh	3.0-5.0
	40-70 mesh	4.0-8.0	40-70 mesh	2.0-4.0
	70-120 mesh	2.0-4.0	70-120 mesh	1.0-2.0
Carryover rate	>1:30		>1:30	
Accuracy	>99%		>99%	
Voltage	180-240V/50-60HZ		180-240V/50-60HZ	
Power(kw)	6.5		5	
Air pressure(Mpa)	0.2-0.6		0.2-0.6	
Air consumption(L/min)	1800		2800	
Weight(kg)	2600		2400	
Dimensions(mm)	3995*1920*1770		2336*2233*2511	

2, Optical sorter for ore grain(26mesh-40mm)



Features

1, The far focal length design solves the problem of sorting in harsh environments such as high dust and high wear.

2, A wide range of ore particles ranging from 26 mesh to 4 cm

Model	KS1200		DKS1280-B	
Output(t/h)	1-4 cm	8.0-12.0	1-4 cm	8.0-15.0
	4-8 mesh	4.0-8.0	4-8 mesh	5.0-9.0
	8-16 mesh	3.0-5.0	8-16 mesh	3.0-7.0
	16-26 mesh	1.0-2.0	16-26 mesh	1.5-3.0
Carryover rate	>10:1		>10:1	
Accuracy	>99%		>99%	
Voltage	180-240V/50-60HZ		180-240V/50-60HZ	
Power(kw)	1.6-2.5		2.0-4.0	
Air pressure(Mpa)	0.4-0.6		0.4-0.6	
Air consumption(L/min)	2400		3800	
Weight(kg)	1250		1850	
Dimensions(mm)	2405*2244*1316		4014*2100*2374	

3, Optical sorter for large particle ore(20-100MM)



Features

- 1, Suitable for ore particles are 20-100mm, completely replacing manually sorting.
- 2, Wet work can be carried out, and the ore with water can be sorted
- 3, For the difference in color difference in the original ore, metal ore, non-metallic ore pre-sorting, rough sorting operation.
- 4, Suitable for sorting non-metallic minerals such as quartz, feldspar, calcite, marble and other metal minerals such as tungsten, manganese, molybdenum, lead and zinc, copper, gold, silver, tin, hematite.

Model	HK1200-1G
Output(t/h)	30-120
Accuracy	>99%
Voltage	180-240V/50-60HZ
Power(kw)	7
Air pressure(Mpa)	0.6-0.8
Air consumption(L/min)	2400
Weight(kg)	1300
Dimensions(mm)	2970*2580*2520

Sorting example



The demonstration video of mineral optical sorting on YouTube

https://www.youtube.com/watch?v=GRn7qjNacAA&list=PLYxgvmvoHadVqj1ft-p8H_2g7U9GfXyhx

Instances of true cases

1,



2,



3,



4,



5,



6,



And so on.....

More information, please feel free to contact us

Vincent Xu | Mineral optical sorting expert

Whatsapp:0086-151 8925 9300

Email:Vincent.xu@colorsorter-cn.com